

EQSS Model6253 – OverWatch Haulotte Star 6S/8S



**** Failure to follow this installation manual will void warranty ****



REV 1.0

26/03/2026

Model6253 OverWatch Installation Manual

Document # DO001820

AUTHORS:
Kieren Grogan

AUTHORISED BY:
Kieren Grogan

CHECKED BY:
Andrew Donegan

DOCUMENT ABSTRACT:

This Installation Manual details the manufacturer's installation instructions for installing the Model6253 OverWatch on a Haulotte Star 6S/8S vertical mast.

PRODUCT NAME:

Model6253 OverWatch Operator Detection System

REFERENCE DOCUMENTS:

DO0001195 Model6253 OverWatch User Manual

CURRENT DOCUMENT REVISION:

1.0

REVISION INFORMATION:

- 1.0 Initial Document Creation for installation on a Haulotte star 6S / 8S vertical mast

Important Information

Information contained in this publication regarding this device's applications and the like, is provided only for your convenience and may be superseded by updates. It is your responsibility to ensure that the application or our equipment meets with your specifications.

EQUIPMENT SAFETY SYSTEMS MAKE NO REPRESENTATIONS OR WARRANTIES OF ANY KIND, WHETHER EXPRESSED OR IMPLIED, WRITTEN OR ORAL, STATUTORY OR OTHERWISE, RELATED TO THE INFORMATION, INCLUDING, BUT NOT LIMITED TO, IT'S CONDITION, QUALITY, PERFORMANCE, MERCHANTABILITY OR FITNESS FOR PURPOSE.

Equipment Safety Systems disclaims all liability arising from this information and its use. Use of Equipment Safety Systems' products as critical components in life support systems is not authorised except with express written approval by Equipment Safety Systems. No licenses are conveyed, implicitly or otherwise, under any Equipment Safety Systems intellectual property rights.



N23041

This is a class A product certified to AS/NZS CISPR 22:2006. In a domestic environment this product may cause radio interference in which case the user may be required to take adequate measures.



Table of Contents

Preparation 5
 Required Tools 5
 Installation Time 5
Installation Instructions 6
 Operator Sensor 6
 Control Module 9
Post Installation Configuration 13
 Overview 13
 Minimum system requirements 13
 Wi-Fi Connection & Web Page Access 13
 Machine Model Selection 14
 Installation Test 15
 Change Model Configuration 15
Harness Drawing AS002004 16
Replacement Parts 17

Preparation

Required Tools

The OverWatch has been designed to be fitted using basic workshop tools. Shown below is a list of tools required to complete the installation

Item	Tool / Description
1	Electric Drill
2	Centre punch
3	Hammer
4	Side Cutters
5	Drill 5.2mm
6	Drill 6.0mm
7	Metric sockets or spanners
8	Needle nose pliers
9	Screw drivers

Installation Time

The suggested time required to install the OverWatch is as detailed below

Task	Estimated Time (Minutes)
Open the operator control box	1
Drilling of all mounting holes for the various components	13
Mechanical assembly	10
Electrical assembly	10
Post installation system tests	10
Close the operator control box	1
Total	45

Installation Instructions

Operator Sensor

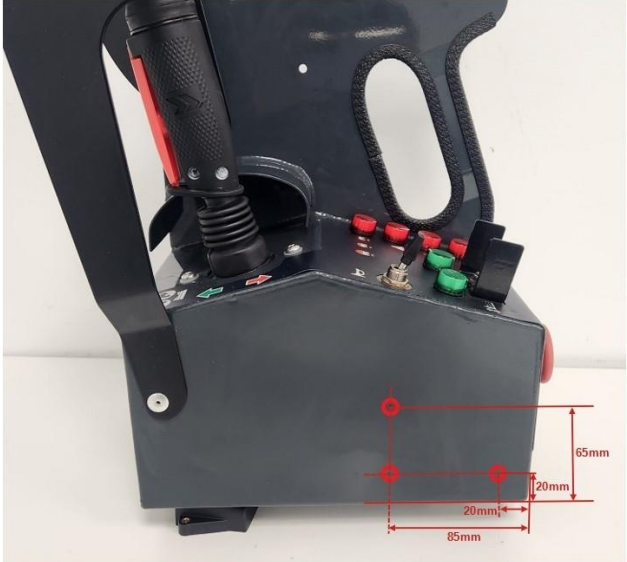
Step	Description	Diagram
1.	Remove the bottom cover of the control box.	
2.	Drill three 5.2mm holes into the metal enclosure in the location as shown. These holes are required to mount the operator sensor mounting bracket.	

3. Drill a **20mm** hole to run the operator sensor M20 Gland into the metal enclosure. The position of the hole is detailed as in the image.

Drill four **5.2mm** holes to install the ECU module and cable gland cover as shown in the image.

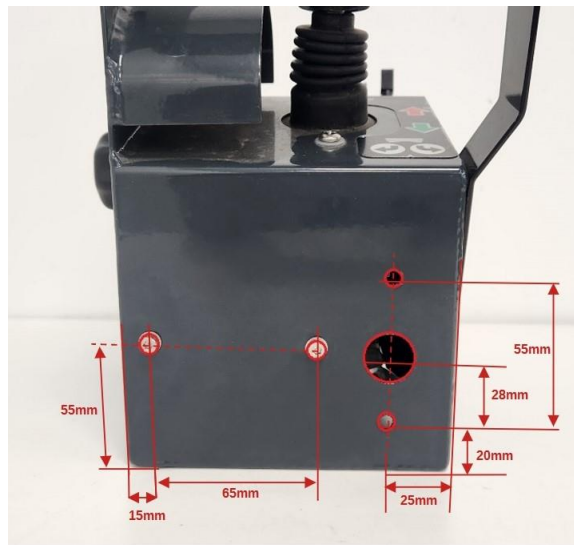

4. **Sensor Mounting Guard**

Attach the operator sensor and guard to the mounting bracket (ME001889) using the M5 nuts and washers. Make sure that the sensor is on the 7.5-degree angle, such that it is twisted outwards from the joystick controller.

The 7.5-degree twist is achieved by rotating the sensor inside the assembly and using the bolt hole as shown in the image.

PARTS LIST			
ITEM	QTY	STOCK NUMBER	DESCRIPTION
1	1	AS002326	Sensor Mounting Guard V2
2	1	AS001910	OverWatch Operator Sensor
3	2	FA001174	Washer, Plain, M5, 304 St. St.
4	2	FA001219	Nut, Hex, M5 x 0.8mm, Nylock



5. Mount the operator sensor and sensor mounting bracket to the control box enclosure by using the nuts, bolts, and washers.

Use the following hardware from the kit.

5 x M5 x 16mm Button Head Screws

5 x M5 Lock Nuts

10 x M5 Washers



6.

Install the cable gland and cable gland cover in the pre-drilled holes.

Route the operator sensor cable as shown in the image and secure the cable to the sensor mounting bracket by using the P-clips.

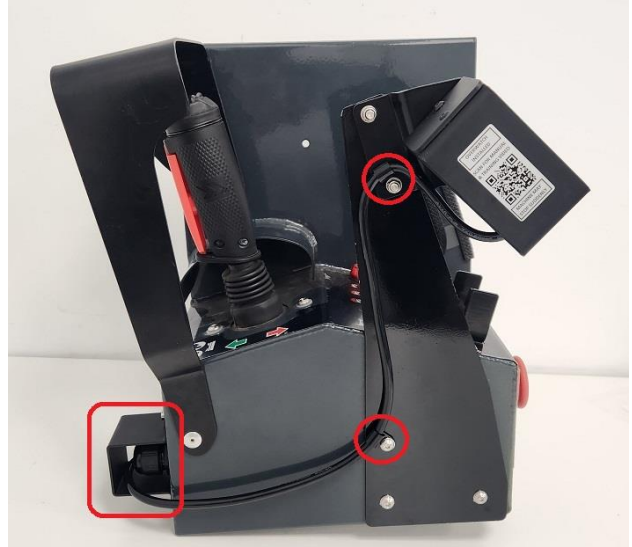

Control Module

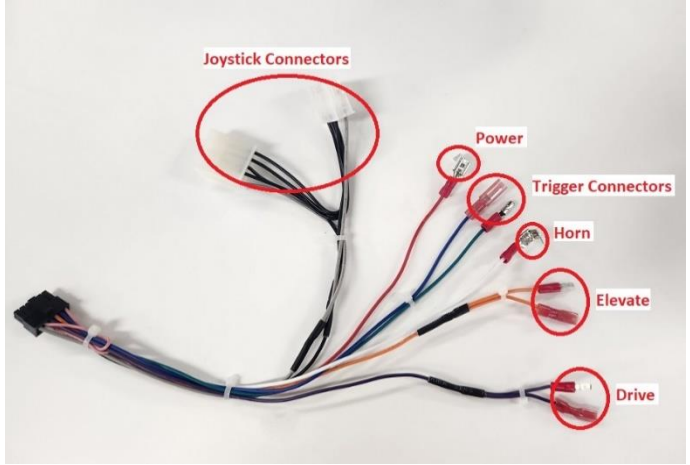
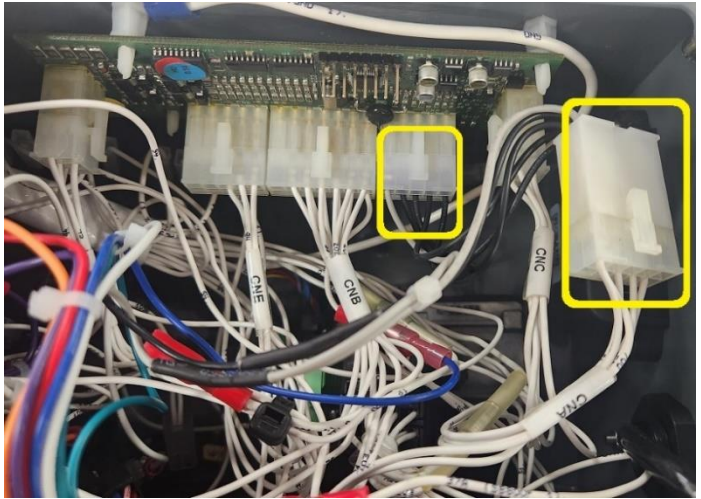
Step	Description	Diagram
1.	Wiring connections are made with AS002004 harness.	
2.	<p>Joystick Connection:</p> <p>Disconnect the 7-pin connector (CNA) from the PCB and install the OverWatch harness connection in series.</p> <p>Warning: Check that the CN-A plug is connected to CN-A and not to CN-E (as the connectors are the same)</p>	

3. **Trigger Connection:**
 Disconnect the bullet connection between the wires **37** and **37A**. Install the OverWatch harness bullet connectors in series. The blue wire will go to the male connector (**wire 37**) and the green wire will go to the female connector (**wire 37A**).

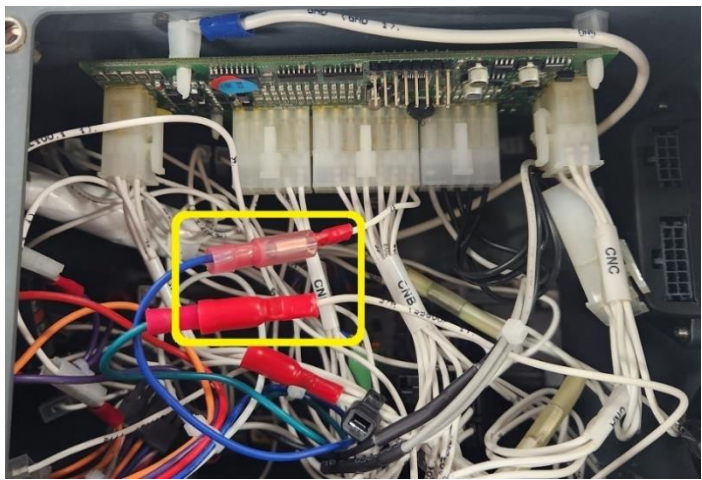

4. **Elevate Connection:**
 At the back of the elevate light, disconnect the connector with wire ID **46** and install the OverWatch orange wire in between the **wire 46** and the elevate light as shown in the image.

Note: Check that the connectors are tight, use needle nose pliers to squeeze the connection if necessary

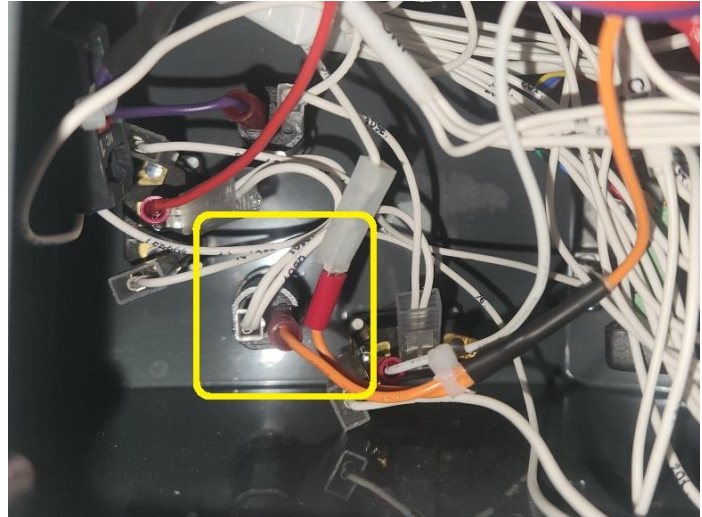

5. **Drive Connection:**
 At the back of the drive light, disconnect the connector with wire ID **94** and install the OverWatch purple wire in between the **wire 94** and the drive light as shown in the image.

Note: Check that the connectors are tight, use needle nose pliers to squeeze the connection if necessary

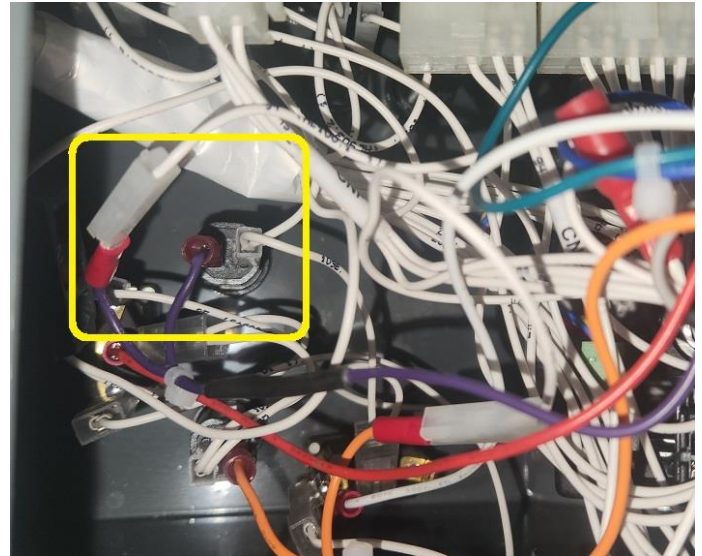

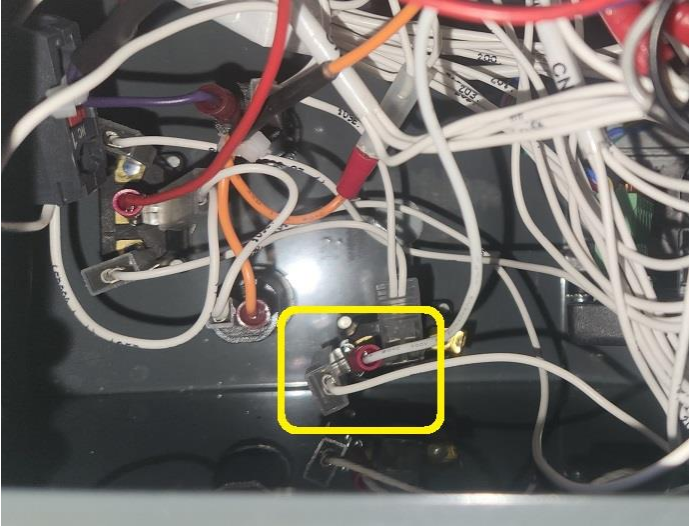
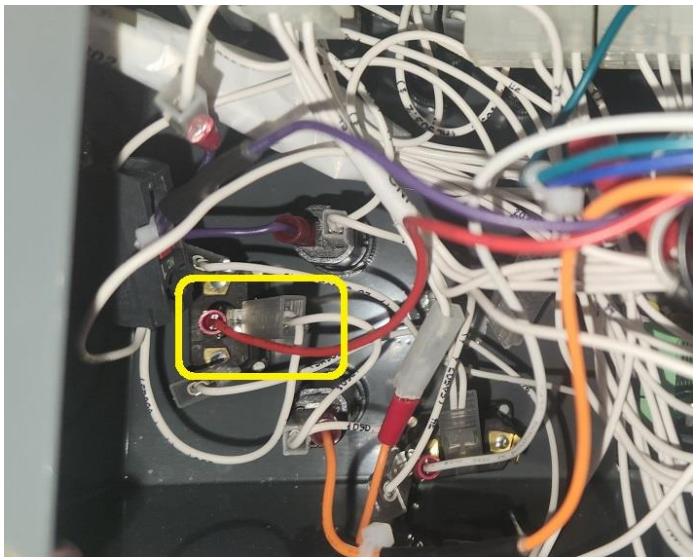
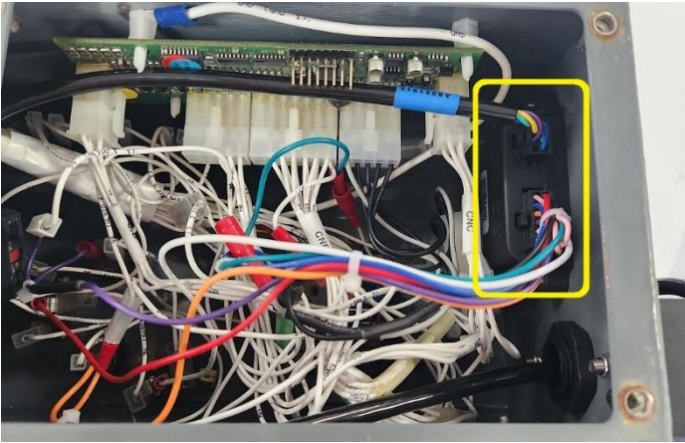
<p>6.</p>	<p>Horn Connection:</p> <p>At the back of the horn switch, disconnect the connector with wire ID 34 and install the white wire from the OverWatch harness inline using the spade connector.</p>	
<p>7.</p>	<p>Power Connection:</p> <p>Disconnect the connector with wire ID 109(b) located on the middle of the drive/lift switch and install the red wire from the OverWatch harness inline using the spade connector.</p> <p>Note: If the Overwatch harness does not have the spade connector but instead a fork connector on the red wire. Power can also be taken from Terminal 1 of the E-stop.</p>	
<p>8.</p>	<p>Mount the ECU module inside the control box by using the supplied M4 bolts and washers.</p> <p>Connect the 8-pin connector from the operator sensor, and the 12-pin connector from the harness into the ECU. Install the cover back onto the bottom of the joystick enclosure.</p>	

9.

Re-attach the bottom plate to the control box.

Care must be taken when closing the box, make sure all internal wires are clear of the box edges and bolt inserts, do not pinch or crush any internal wires when closing the boxes.



Post Installation Configuration

Overview

After the system has been installed it must be configured with the parameters to suit the machine. Follow the instructions below to configure the OverWatch.

Minimum system requirements

Any smart phone, tablet or laptop that meets the following requirements:

- The device can connect to a Wi-Fi access point
- The device has an up to date web browser installed. Firefox, Chrome or Safari are recommended.

Wi-Fi Connection & Web Page Access

To enable the Wi-Fi connection on the OverWatch to complete the configuration follow the steps below.

1. Power down the platform control box with the ESTOP
2. Wait 5 seconds
3. Power up the platform control box with the ESTOP
4. While standing **in front of the operator sensor**, switch on the OverWatch
5. As the welcome chime starts to play, cover the sensor. The LED will flash white then black to acknowledge.
6. Remove your hand from the sensor. The LED will flash white then black to acknowledge.
7. After covering then uncovering the sensor this way 2 more times, "Wi-Fi On" will be announced
8. On your Wi-Fi enabled device (laptop, tablet, smartphone, etc), show the available wireless networks
9. Select the wireless network (starts with "overwatch") to connect to the OverWatch
10. When prompted, enter the **password 12345678**
11. Open your preferred web browser (Chrome, Firefox, Safari)

Enter the following into the address bar <http://192.168.4.1> to open the OverWatch main page

Machine Model Selection

Follow the instructions below to configure the OverWatch.

1. Select the Setup option depending if the machine is a **6S** or **8S** - **Select the correct model.**
2. If there is a password field at the bottom of the page, follow the instructions in Change Model Configuration to obtain the password and enter the password field
3. Select the EWP Model from the drop-down list and click Set
4. Click on Proceed to test to begin the installation test

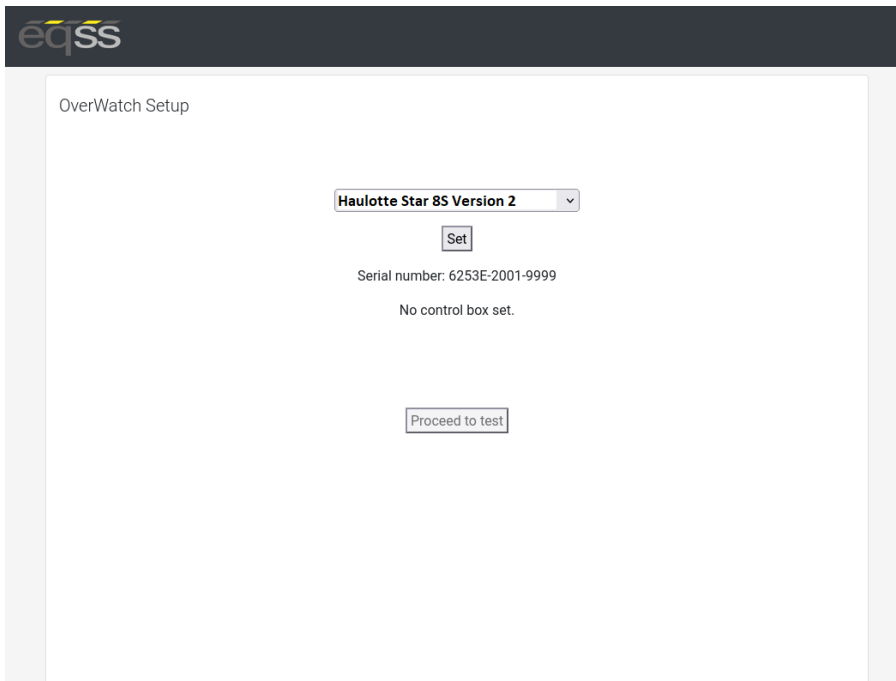

The screenshot shows the 'OverWatch Setup' web interface. At the top left is the 'eqss' logo. Below it, the text 'OverWatch Setup' is displayed. In the center, there is a dropdown menu with 'Haulotte Star 8S Version 2' selected. Below the dropdown is a 'Set' button. Underneath, the serial number '6253E-2001-9999' is shown, followed by the text 'No control box set.' At the bottom of the form is a 'Proceed to test' button.

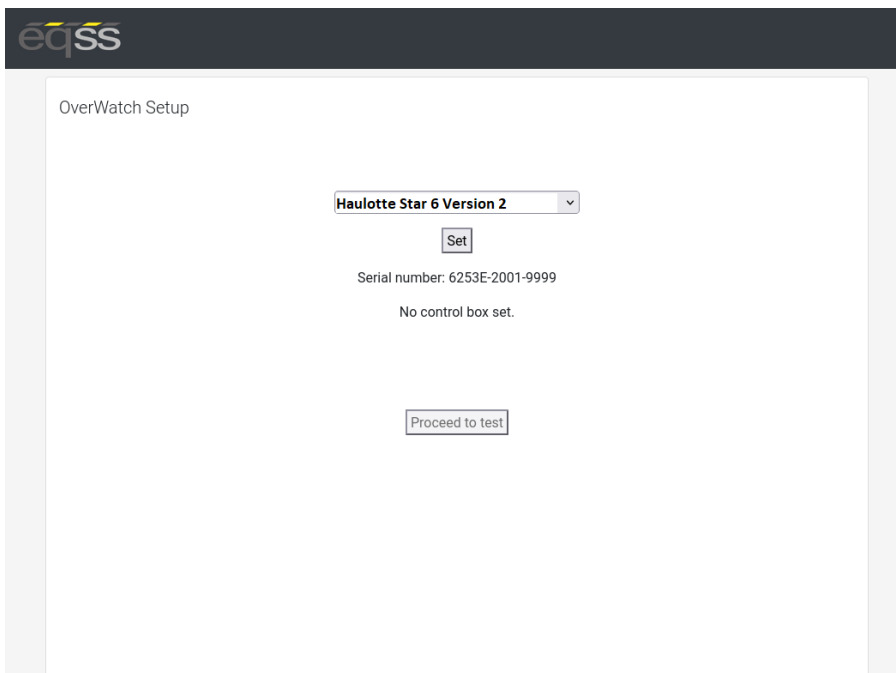

The screenshot shows the 'OverWatch Setup' web interface. At the top left is the 'eqss' logo. Below it, the text 'OverWatch Setup' is displayed. In the center, there is a dropdown menu with 'Haulotte Star 6 Version 2' selected. Below the dropdown is a 'Set' button. Underneath, the serial number '6253E-2001-9999' is shown, followed by the text 'No control box set.' At the bottom of the form is a 'Proceed to test' button.

Installation Test

After the model configuration has been set or updated an Installation Test must be performed. This will ensure the installation has been correctly performed and the OverWatch is functioning correctly. Follow the instructions on the web page to complete the Installation Test.

Change Model Configuration

To reconfigure the OverWatch for a different model requires an authorisation password. The authorisation password is generated from the EQSS website. The EQSS website requires a login username and password, contact EQSS for these details.

Follow the instructions below to obtain an authorisation password. It is important to note that each ECU has a unique serial number and a unique password.

1. Open your web browser and enter the following into the address bar <http://www.eqss.com.au/overwatch> to open the Login page
2. Enter your username and password
3. Enter the ECU serial number which is shown on the setup page or on the ECU serial number sticker, also enter the owner and model details of the EWP and then click Generate Hash
4. The generated Hash code or password can be used to change the model configuration.

Harness Drawing AS002004

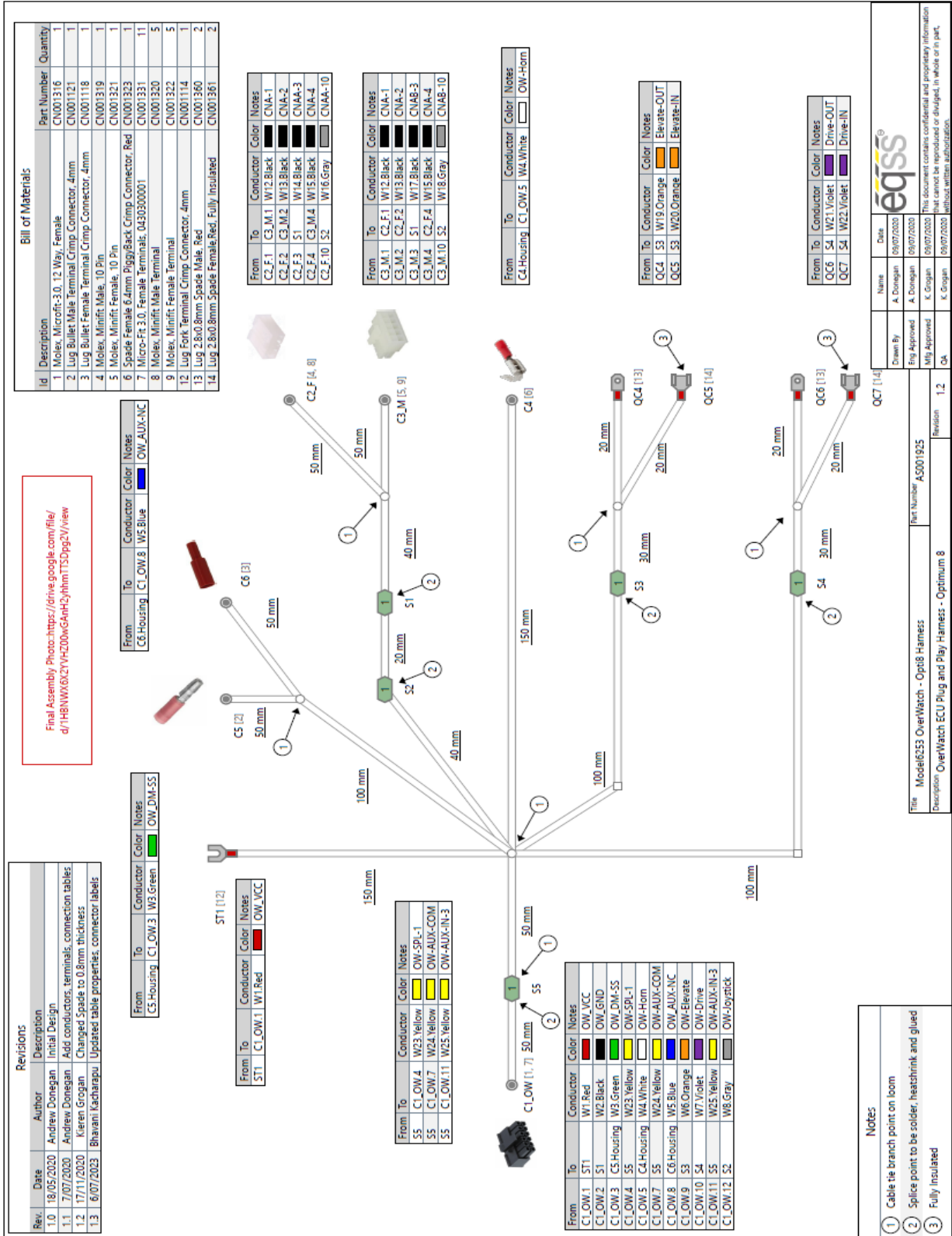

Replacement Parts

Replacement parts for this OverWatch kit are available from EQSS, please email sales@eqss.com.au

Shown below are the part numbers for the major components included in this model specific kit.

Part Number	Description
AS002538	OverWatch - Complete kit Haulotte 6S/8S Vertical Mast
AS001910	OverWatch - Operator Sensor with M20 gland
AS001916	OverWatch - Electronic Control Unit (ECU)
AS002004	OverWatch - Haulotte 6S/8S Harness
AS002326	OverWatch - Sensor Guard V2
ME001889	OverWatch - Sensor Bracket
ME001902	OverWatch - Sensor Mounting Bracket